

Booths: 6'Dx10'W Tables: 6'x2' foyer table

Exhibit space Includes:

One (1) sign with the name of organization and booth ID number

One (1) wastebasket

Two (2) chairs

One (1) 6'x2' custom draped table

The entire exhibit area is carpeted

Any additional equipment, special lighting or decorations should be arranged through Exhibits, Inc., the official R&S Center decorator.

UPDATED 5/1/19

RESERVE SPACE PRIOR TO
MAY 15 TO SAVE \$50.
SAVE \$300 SIGN-UP FOR A BOOTH
FOR 2019 & 2020.
(SEE CONTRACT FOR DETAILS.)

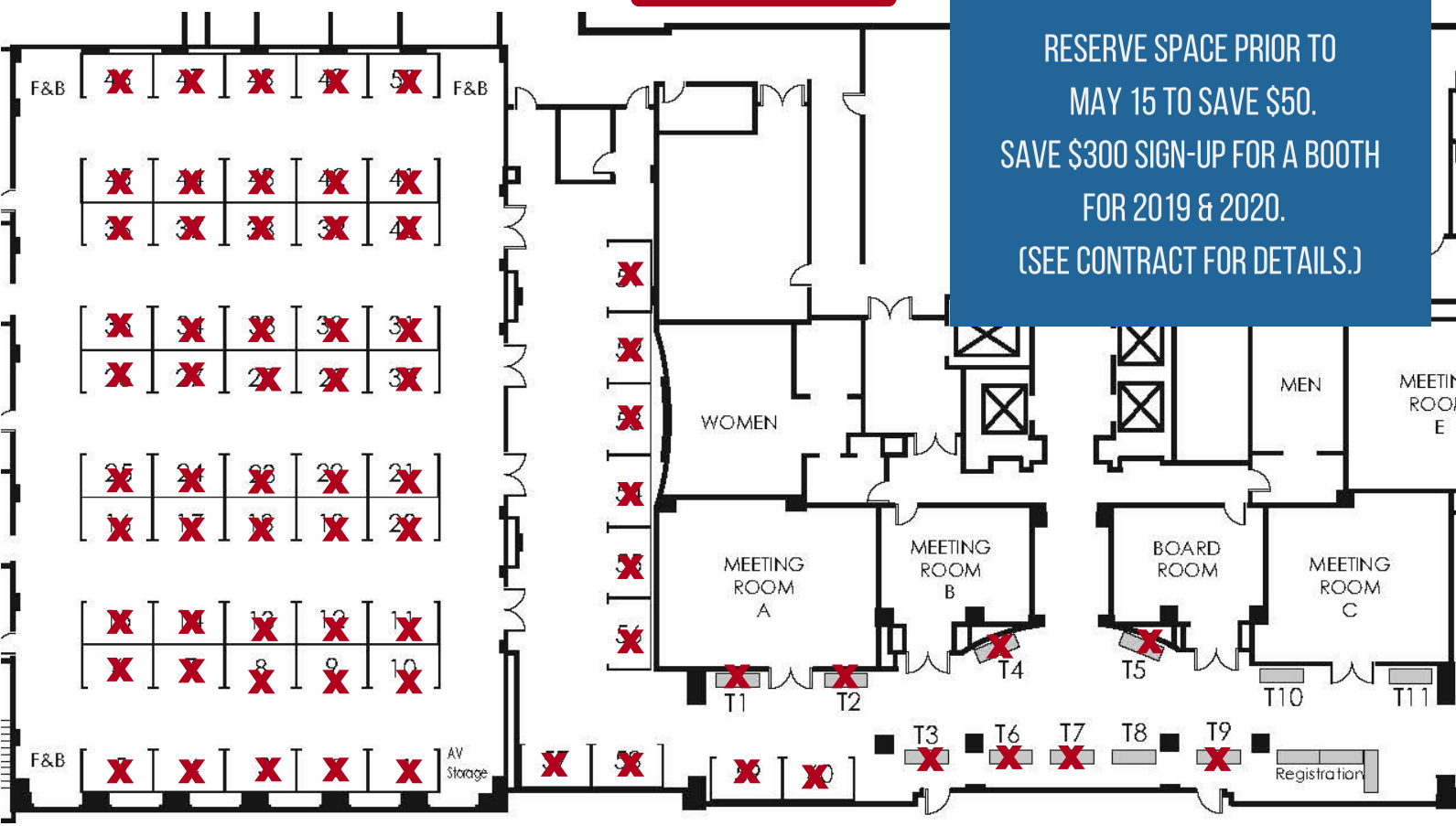

- | | | | | |
|------------------------------|--------------------------------|---------------------------------|------------------------------|-------------------------------|
| 1. Prime Ins. | 15. First Atlantic Restoration | 29. Houston Int. Insurance Grp. | 43. SE Personnel Leasing | 58. Risk Placement Services |
| 2. Insurance House | 16. Leavitt Group | 30. Jackson Sumner & Assoc. | 44. BIIA | 59. Rider Insurance |
| 3. Titan Web Marketing | 17. Nationwide | 31. Xanatek, Inc. | 45. ServPro | 60. Imperial PFS* |
| 4. Watney Insights Network | 18. SolePro | 32. Continental Underwriters | 46. Commonwealth Undwrt | T1. Rockingham In Co |
| 5. Donegal Group | 19. Iroquois Mid-Atlantic | 33. Big "I" National Programs | 47. Utica First Ins. Company | Commercial Elite |
| 6. Hanover Excess & Surplus | 20. Harford Mutual Ins. | 34. Orchid Insurance | 48. Triumph Com. Finance | T2. Assurant Flood Solutions |
| 7. Xpress-Pay | 21. Penn Lumbermens Mutual | 35. Employers Insurance Grp | 49. Mountain Empire Agency | T3. VFSC/SwissRe |
| 8. Trusted Flood Brokerage | 22. Selective Insurance Co. | 36. Landin, Inc. | 50. Stonewood Insurance | T4. ePay Policy* |
| 9. Johnson & Johnson | 23. FFVA Mutual | 37. Narragansett Bay Ins Co. | 51. Amerisafe | T5. Hagerty |
| 10. AFCO Credit Corp. | 24. Sagesure | 38. Northern Neck Insurance | 52. Main St America Group | T6. Acquity Insurance |
| 11. Midwestern Ins. Alliance | 25. Goodville Mutual | 39. ICW Group | 53. Belfor Restoration | T7. Universal Property & Cas. |
| 12. Zenith Insurance Co. | 26. Motorist Insurance Grp. | 40. TAPCO Underwriters | 54. Markel | T8. |
| 13. Safeco/Liberty Mutual | 27. Philadelphia Ins. Co. | 41. EZ Lynx | 55. Genesee General | T9. DRIVESMART Virginia |
| 14. Applied Underwriters | 28. Mercury Insurance Grp. | 42. Berkshire Hathaway Guard | 56. EVOLVE MGA | T10. |
| | | | 57. Grange Insurance | T11. |

X = Sold

*IIAV Endorsed Vendor